

Technical data sheet - Accolade CC



NB model shown has armrest in Walnut with 10% gloss lacquer finish.

Description

A high specification chair suitable for fixed, removable or retractable settings. The Accolade CC offers a luxurious pocket sprung seat and elegant timber armrests. With theatrical styling, the chair is suitable for use as a fixed or removable chair, or on retractable platforms.

Features

- Designed for comfort with good lumbar support
- Tested and certified to the highest level of the strength standard BS EN 12727(2000) - Grade 4
- Components tested for effect on indoor air quality: emissions are within acceptable limits specified within the BREEAM, LEED and WELL standards. Details on request.
- Slim profile creating safe and easy access
- Enclosed spring-tip mechanism for safety and silent action
- Optional armrest in ABS, timber, or timber with upholstered pad
- Ideal for stand alone applications, or for use on TX platform systems; the armrests automatically fold away as the chair folds down on to the platform
- Also suitable for use on an aluminium rail, which can be curved by up to 3 degrees - ideal for arena environments
- Optional plastic protection panels for outer back and seat pan.

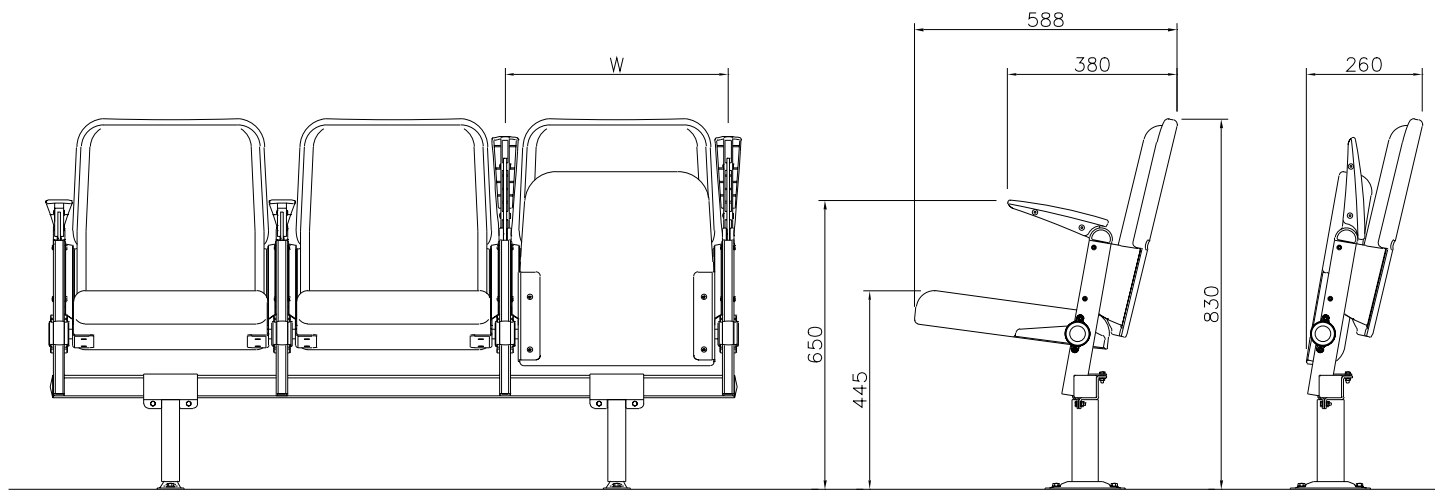

Drawing shows beam mounted, tread fixed chair. Height measurements are taken at seat centre. All dimensions are nominal.

Seat widths

450, 460, 480, 500, 520mm

Note: 450mm width available for fully upholstered chairs only.

460mm width available for fully upholstered chair or chair with plastic protection panel to outer back.

Minimum width if plastic under seat panel is required = 480mm.

Fixing methods

Tread fixed, riser fixed, beam mounted (tread or riser fixed), fold-down (for TX Telescopic Platforms) or matrix (for flat floor configurations).

Finishes

Frame

Metal parts in epoxy powder coat, black RAL 9005. Other colours available on special request, please consult Audience Systems for availability. Tube end plugs in black RAL 9005.

Seat and back

Upholstered in fabric to customer choice and availability. Plastic seat and back covers in black RAL 9005.

Armrests / Leg top caps (for chairs with no arms)

Black RAL 9005

Specification

Seat

50mm polyurethane CMHR/CME foam on 15mm plywood core, all fully upholstered. Optional protection panel to the underside is injection moulded grey polypropylene.

Backrest

45mm polyurethane fabricated CMHR/CME foam on 12mm thick preformed plywood, upholstered. Optional protection panel to the outer back is injection moulded grey polypropylene.

Chair frame

Fabricated steel construction with associated steel pressings for fixing seat and back.

Chair rail (aluminium rail model only)

Extruded aluminium rail

Seat tip up mechanism

Innovative cast aluminium pivot. The seat pan automatically tips when not in use. Entire mechanism is housed in a protection cover for safety, preventing any possibility of finger entrapment.

Armrest

Optional armrest in injection moulded ABS or solid timber

Tube end plugs

Injection moulded polyethylene.

Standards

Strength and stability

Satisfies the requirements of BS EN 12727:2000 Grade 4 (severe).

Flammability

Upholstery fabric and foam comply with BS 5852 1990 (sources BS EN 1021-1, 0; BS EN 1021-2, 1 and 5) or European or other standards as specified.

Options and accessories

- Seat numbers
- Aisle letters
- Armrests