

Technical data sheet - Espace 628CC

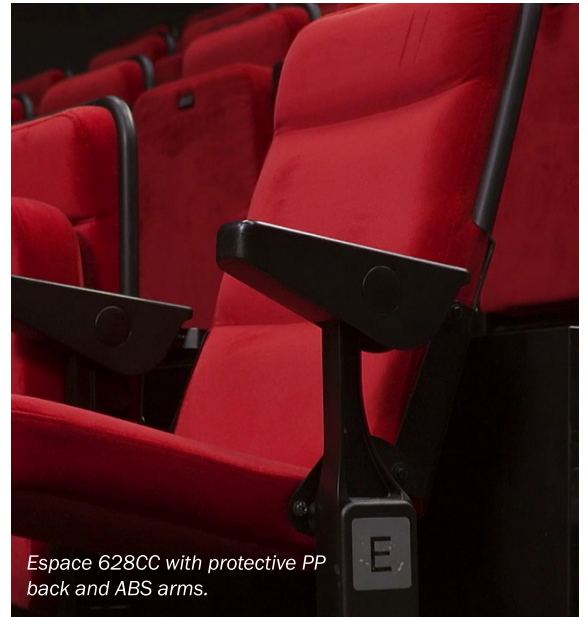

Espace 628CC with timber outer backrest and curved timber armrests on TX platforms



Espace 628CC with protective PP back and ABS arms.

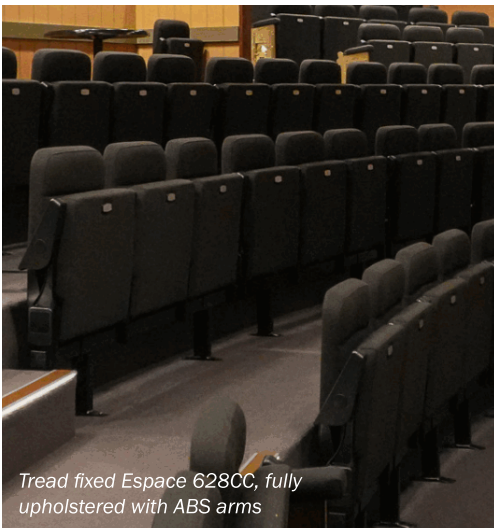

Tread fixed Espace 628CC, fully upholstered with ABS arms



Tread fixed Espace 628CC with protective polypropylene covers to seat and back

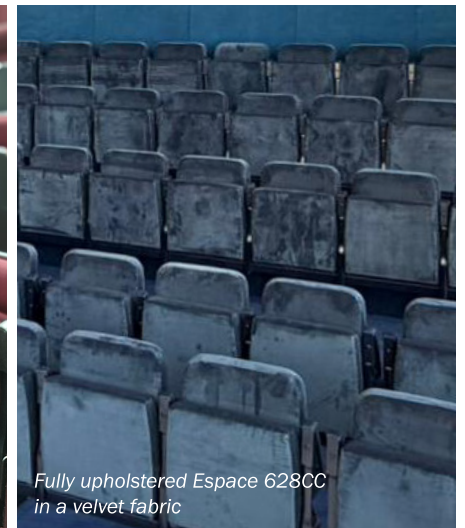

Fully upholstered Espace 628CC in a velvet fabric

Description

Offering all the styling and comfort of an auditorium chair combined with complete flexibility, the Espace 628CC is suitable for both fixed seating and telescopic installations. The pocket sprung seatpan provides a luxurious feel to the chair and its unique tipping action creates seated areas with wide, safe seatways.

Features

- Self tipping design, with auto tip armrest and the backrest acting as a counterweight
- Compact dimensions when closed
- High backrest for concert-level comfort
- Optional protective plastic wraparound back
- Pocket sprung seat core for outstanding support
- Choice of armrests including an elegant curved solid timber design
- Tested for effect on indoor air quality: emissions are within acceptable limits specified within the BREEAM, LEED and WELL standards. Details on request.*

*model tested was fully upholstered with ABS armrests.



Rear of seat with plastic back (fixed back model)

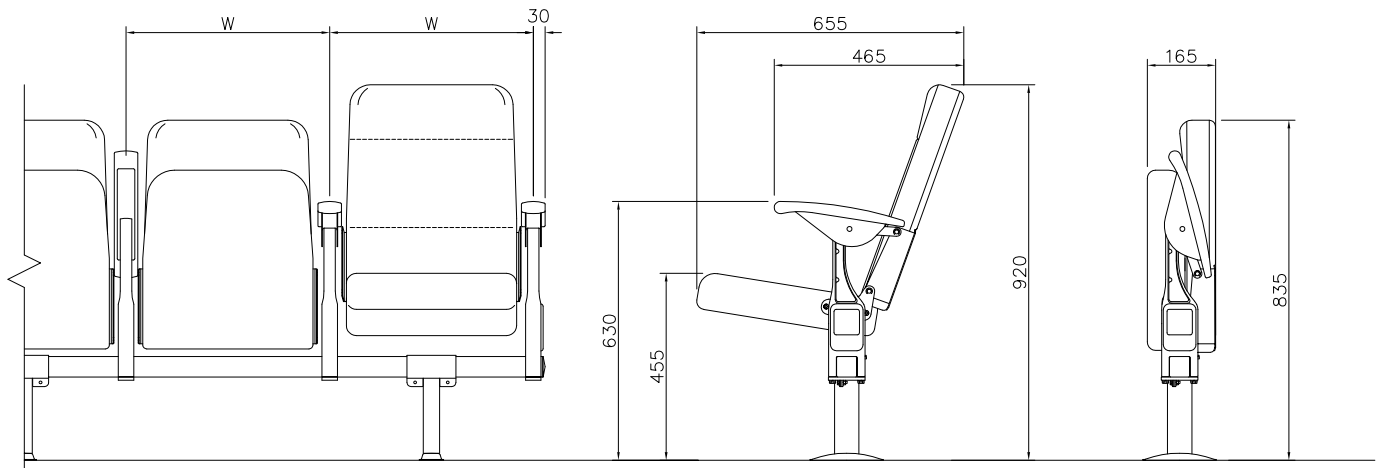

Drawing shows beam mounted (tread fixed) chairs with no plastic panel to the back or seat and curved timber armrests. Height measurements are taken at chair centre. All dimensions are nominal.

Seat widths

480, 490, 500, 510, 520, 530, 540, 550mm (without plastic back)

480, 500, 520mm (with plastic back)

Fixing methods

Beam mounted (tread or riser fixed), fold-down (for TX Telescopic Platforms) or matrix (for flat floor configurations).

Specification

Seat

Plywood core with pocket coiled springs, with polyurethane CMHR foam wrap, fully upholstered in fabric to customer choice and availability.

Options:

- Wraparound plastic under-seat panels in injection moulded polypropylene, colour black RAL 9005.
- Veneered 'show-wood' timber under-seat panels - plain, slotted or perforated designs.

Backrest

Composite CMHR foam, 45 - 65mm thick on 12mm thick preformed plywood, upholstered in fabric to customer choice and availability.

Options:

- Wraparound plastic back panels in injection moulded polypropylene, colour black RAL 9005.
- Veneered 'show-wood' timber back panels

Chair frame

Die cast one piece aluminium arm stanchion incorporating seat pivot assembly clamped to 50 x 50 x 2.5mm steel tube cross beam. Finish: epoxy powder coat, black RAL 9005.

Armrest

Curved timber with clear lacquer (options - timber block, black ABS or upholstered).

Seat tip up mechanism

Counterweight tip up.

Tube end plugs

Injection moulded low density polyethylene, black RAL 9005.

Standards

Strength and stability

The chair satisfies the requirements of BS EN 12727:2000 (Tests 6.3, 6.4, 6.5, 6.6, 6.7, 6.8, 6.9, 6.11, 6.13, 6.14) to level 4 (severe).

Flammability

Upholstery fabric and foam comply with BS 5852 1990 (sources BS EN 1021-1, 0; BS EN 1021-2, 1 and 5) or European or other standards as specified.

Options, variations and accessories

Accessories

- Seat dampner for soft action seat closing
- Timber outer back
- Protective plastic outer back
- Seat numbers
- Aisle letters
- Cupholder

Variations

- Upright backrest geometry can be specified for correct posture in upper tiers.
- A fixed back version suitable for arena environments is available, where the back does not move as the seat is tipped up (see below).

